

Charging Instruction

- 1 Insert 1 to 4 pieces of rechargeable NiMH AA / AAA size battery into the battery compartment. Make correct contact for polarity (+ and -) according to the sign in the battery compartment.

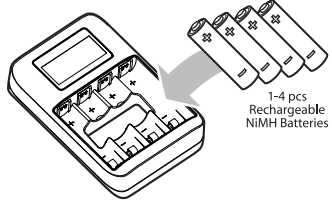

- 2 Connect the charger with supplied micro USB cable into a standard USB port (5V DC 1A) (not included). The LCD will indicate the proper charging status.

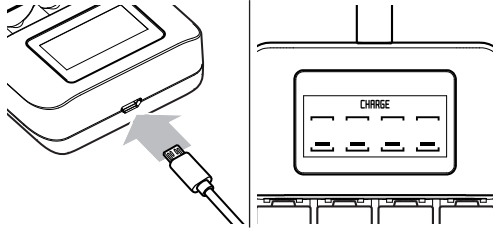

Tenenergy AA/AAA Battery Charger

For Ni-MH rechargeable batteries

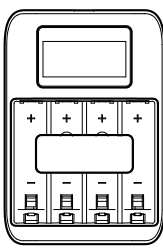

PN 01474

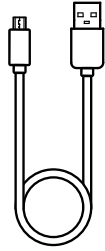

Supplied USB-A to Micro USB Cable

Features

- USB power input for worldwide use.
- Recharges 1 to 4 pieces of AA/AAA, NiMH batteries at a time.
- LCD display for quick and easy to read status.
- Built-in safety protections like Negative Delta V cut-off, safety timer, reverse polarity, bad cell, and short circuit protections.

Specifications

Model	01474
Input	5V DC 1A (Micro USB)
Output	AA 450mA (1-4pcs) AAA 450mA (1-4pcs)
Accessory	50cm (19 in) Micro USB to USB-A cable

Estimated Charging Time

(5V 1A USB power adapter, not included)

Size	Pcs	Charging Current	Capacity	Time
AA	1-4	450mA	2000 - 2500 mAh	4-6 hours
AAA	1-4	450mA	800 - 1000 mAh	2-3 hours

* Charge time will vary depending upon the brand, capacity and condition of batteries being charged.

Battery Status	Start Charging	Completed
Charging in progress		
Charging completed	CHARGE	
One or more bad cell / Alkaline detected	FINISH	
	ERROR*	

*It could be any of its 4 bays, indicated by flashing bottom and top brackets.

- 3 The charger detects the status of each of the cells in the battery compartment. If any batteries are unsuitable for charging, i.e. short circuit or reversed polarity, the wording "ERROR" will be shown on the LCD screen and the battery icon will flash. Please correct the battery polarity / remove and replace the damage battery.

- 4 Remove the batteries from the charger when the charging is finished. Unplug the charger and remove the batteries from the charger when not in use.

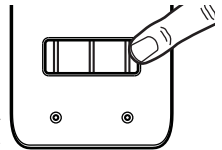

IMPORTANT SAFETY INSTRUCTIONS:

1. SAVE THESE INSTRUCTIONS & CAREFULLY FOLLOW THEM, TO REDUCE THE RISK DANGER OF FIRE OR ELECTRIC SHOCK.
2. This charger is intended for Ni-MH/NiCd rechargeable batteries only. Attempting to charge non-rechargeable batteries may cause personal injury and damage to the charger.
3. Do not expose charger to water or moisture. For indoor usage only.
4. Remove from power when not in use.
5. Do not operate the charger if it has been subjected to shock or damage. Take it to a qualified serviceman for repair.
6. Do not disassemble the charger. Incorrect reassembly may result in a risk of electric shock or fire.
7. Unplug the charger from USB port before attempting any maintenance or cleaning. Use damp cloth to clean the surface, do not immerse into water.
8. Before scrapping your charger, remove batteries from the unit and recycle or dispose the batteries safely.
9. This appliance is not recommended for children under 8 years old or persons with reduced physical, sensory, or mental capabilities. Adult supervision is recommended to prevent hazards that may be involved.
10. Do not let children play with the appliance, it is not a toy.
11. Cleaning and user maintenance shall not be made by children without adult supervision.

This device complies with Part 15 of the FCC Rules. Operation is subject to the following two conditions: (1) This device may not cause harmful interference, and (2) This device must accept any interference received, including interference that may cause undesired operation.

Warning: Changes or modifications to this unit not expressly approved by the party responsible for compliance could void the user's authority to operate the equipment.

NOTE: This equipment has been tested and found to comply with the limits for a Class B digital device, pursuant to Part 15 of the FCC Rules. These limits are designed to provide reasonable protection against harmful interference in a residential installation. This equipment generates, uses, and can radiate radio frequency energy and, if not installed and used in accordance with the instructions, may cause harmful interference to radio communications. However, there is no guarantee that interference will not occur in a particular installation. If this equipment does cause harmful interference to radio or television reception, which can be determined by turning the equipment off and on, the user is encouraged to try to correct the interference by one or more of the following measures:

- (1) Reorient or relocate the receiving antenna.
- (2) Increase the separation between the equipment and receiver.
- (3) Connect the equipment into an outlet on a circuit different from that to which the receiver is connected.
- (4) Consult the dealer or an experienced technician for help.